

DEMONSTRATOR HOOD:

This hood is designed to allow the operator to demonstrate and still permit the safe viewing via three sides of 1/4" thick laminated safety glass. The hood has applications for use in teaching institutions and where ever enlarged viewing is necessary. The hood exterior is constructed of furniture steel and painted with a corrosion resistant finish. The interior is constructed of a white poly resin with adjustable baffles at one end top and bottom. A two tube fluorescent light is standard along with the two painted steel sash and galvanized exhaust duct. This fume hood is used in restricted air volume exhaust systems and variable air volume systems.

Besides the standard louvered front panels there are two other options, one is the non-louvered version of the current front panel. The second is the Add Air System that uses larger fronts with separate intake ducts that allow air from another source to be exhausted through and out of the fume hood. For more information on this unit see the accessories section in this catalog.

Services –

This unit typically does not offer many accessories because there is a lack of wall space within the hood. Options include an incandescent vapor proof light, light switch, blower switch, and electrical receptacles. Deck mounted plumbing fixtures are offered including special chemical resistant finished types.

DEMONSTRATOR STANDARD FUME HOOD SIZES					
MODEL NO.	"A" WIDTH	HEIGHT	DEPTH	EXHAUST DUCT	BLOWER PRT. NO.
100-047-DFH	47"	48"	31"	10" DIAMETER	1DM-RTB-047
100-048-DFH	48"	48"	31"	10" DIAMETER	1DM-RTB-048
100-059-DFH	59"	48"	31"	10" DIAMETER	1DM-RTB-059
100-060-DFH	60"	48"	31"	10" DIAMETER	1DM-RTB-060

Blowers are single or three phase with explosion proof optional

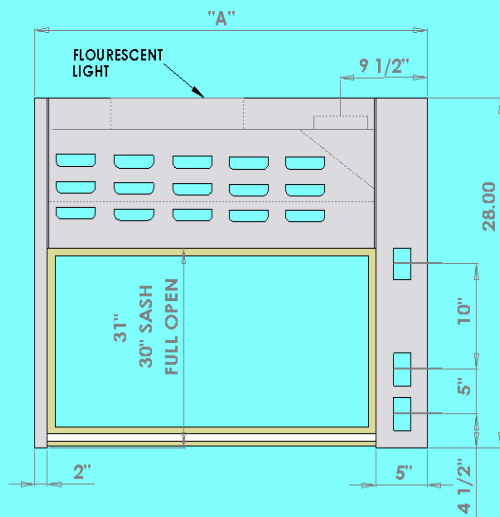

FRONT VIEW

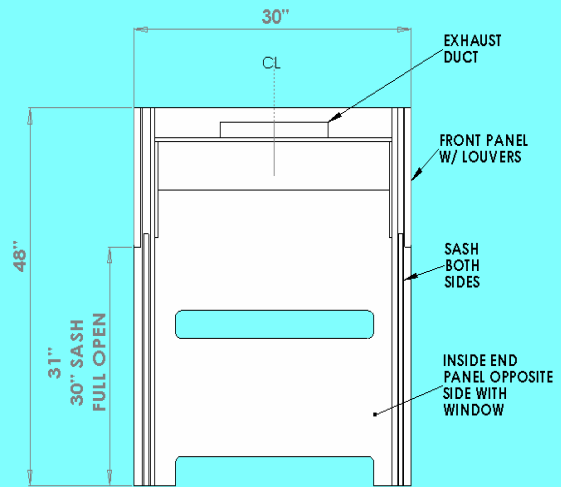

SIDE VIEW

This fume hood has been designed for the educational market where viewing from multiple sides aids in demonstrating or teaching students. The two larger end posts can accommodate electrical outlets along with blower and light switches. The hoods counterweight configuration does not permit plumbing in the walls.

The Demonstrators end window is trimmed out in polished stainless steel.

The hood can also be designed to incorporate a sash lock for security reasons when the hood is not in use.

Applications: K thru university

Added Accessory Options: Sash position sensor with alarm, sash locks, sash stops, sash material options, and electrical options. Deck mounted plumbing fixtures are offered with standard chrome plated or a chemical resistant finish. Remote controls are typically installed in the supporting casework. Work surface options as well from epoxy resin to phenolic.